

## Schottky Barrier Diode

### FEATURES

- Low current rectification
- Low forward voltage
- SOD523 Micro SMD package
- RoHS compliant
- Matte Tin (Sn) Lead finish(Pb-Free)
- Cathode Band / Device marking
- UL-94 V-0 / Green EMC

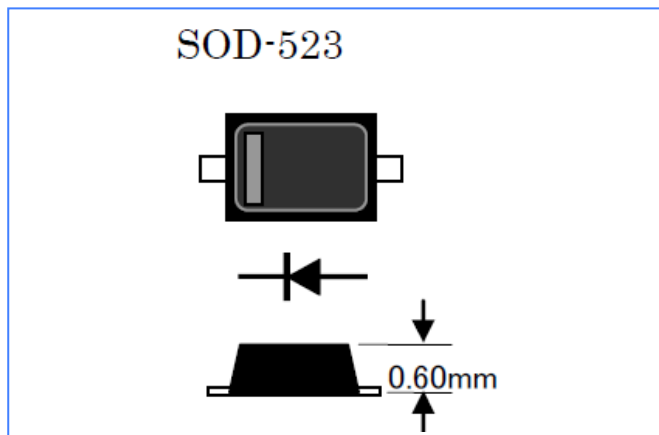

### Maximum Ratings (Ta = 25 °C)

Symbol	Parameter	Value	Units
$V_{RRM}$	Repetitive Peak Reverse Voltage	40	V
$V_{RWM}$	Working Peak Reverse Voltage	40	V
$I_O$	Continuous Forward Current	200	mA
$I_{FSM}$	Non-Repetitive Peak Forward Surge Current <sup>**1</sup>	1.0	A
$P_D$	Power Dissipation	200	mW
$T_J$	Junction Temperature	150	°C
$T_{STG}$	Storage Temperature	-55 to +150	°C

### Electrical Characteristics Ratings at 25 °C ambient temperature unless otherwise specified

Symbol	Parameter	Conditions	Min	Max	Units
$V_{BR}$	Reverse Voltage	$I_R = 500\mu A$	40		V
$V_F$	Forward Voltage	$I_F = 100mA$		0.55	V
		$I_F = 200mA$		0.59	V
$I_R$	Reverse current	$V_R = 10V$		0.55	$\mu A$
		$V_R = 40V$		10	$\mu A$

### Ordering Information

Device	Package	Shipping	Tape wide
YSD200D5-40	SOD523	Tape & Reel 3000pcs /7" Reel	8 mm

**Package Dimensions**

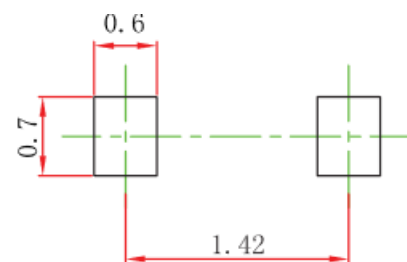
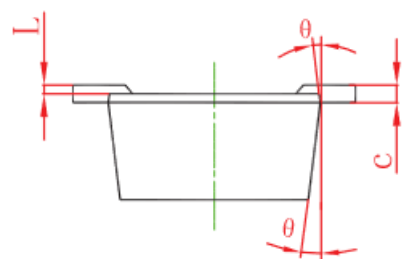
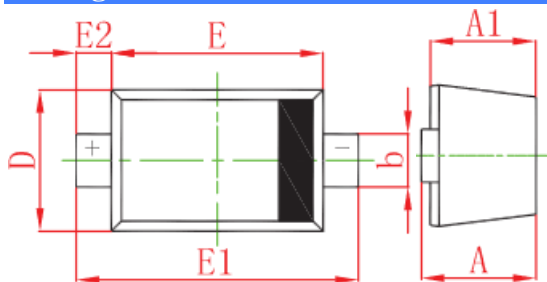

Symbol	Dimensions in mm		Dimensions in inches	
	min	max	min	max
A	0.510	0.770	0.020	0.031
A1	0.500	0.700	0.020	0.028
b	0.250	0.350	0.010	0.014
c	0.080	0.150	0.003	0.006
D	0.750	0.850	0.030	0.033
E	1.100	1.300	0.043	0.051
E1	1.500	1.700	0.059	0.067
E2	0.200REF		0.008	
L	0.010	0.070	0.001	0.003
θ	7° REF		7°REF	

**Disclaimer**

Specifications are subject to change without notice.

The device characteristics and parameters in this data sheet can and do vary in different applications and actual device performance may vary over time.

Users should verify actual device performance in their specific applications.